

GET READY HOUSTON





LATEST DESIGN UPDATES

ANTOINE DRIVE: US 290 - W. MT. HOUSTON

JUNE 4, 2026



THE PROJECT TEAM

**SHERRY CANG
ROWAIDAH AYOUB**

**CITY OF HOUSTON
CITY OF HOUSTON**

**MUHAMMAD ALI
KARAM QADDO
DEREK ST. JOHN**

**HR GREEN
HR GREEN
HR GREEN**

**TOGETHER
WE CREATE
A STRONG
FOUNDATION
FOR HOUSTON
TO THRIVE.**

 **HOUSTON
PUBLIC WORKS**

LET'S TALK ABOUT

- Project overview
- Design updates
- Who to contact



DESIGN UPDATES

**ROWAIDAH AYOUB, PE, ENV SP
SUPERVISING ENGINEER, INFRASTRUCTURE
CITY OF HOUSTON, HOUSTON PUBLIC WORKS**



Antoine Drive: US 290 to West Mount Houston

TYPE PAVING

EST. BUDGET \$137 MILLION

PHASE DESIGN

PROJECT MANAGER

ROWAIDAH AYOUB - CITY OF HOUSTON
ENGAGE@HOUSTONTX.GOV

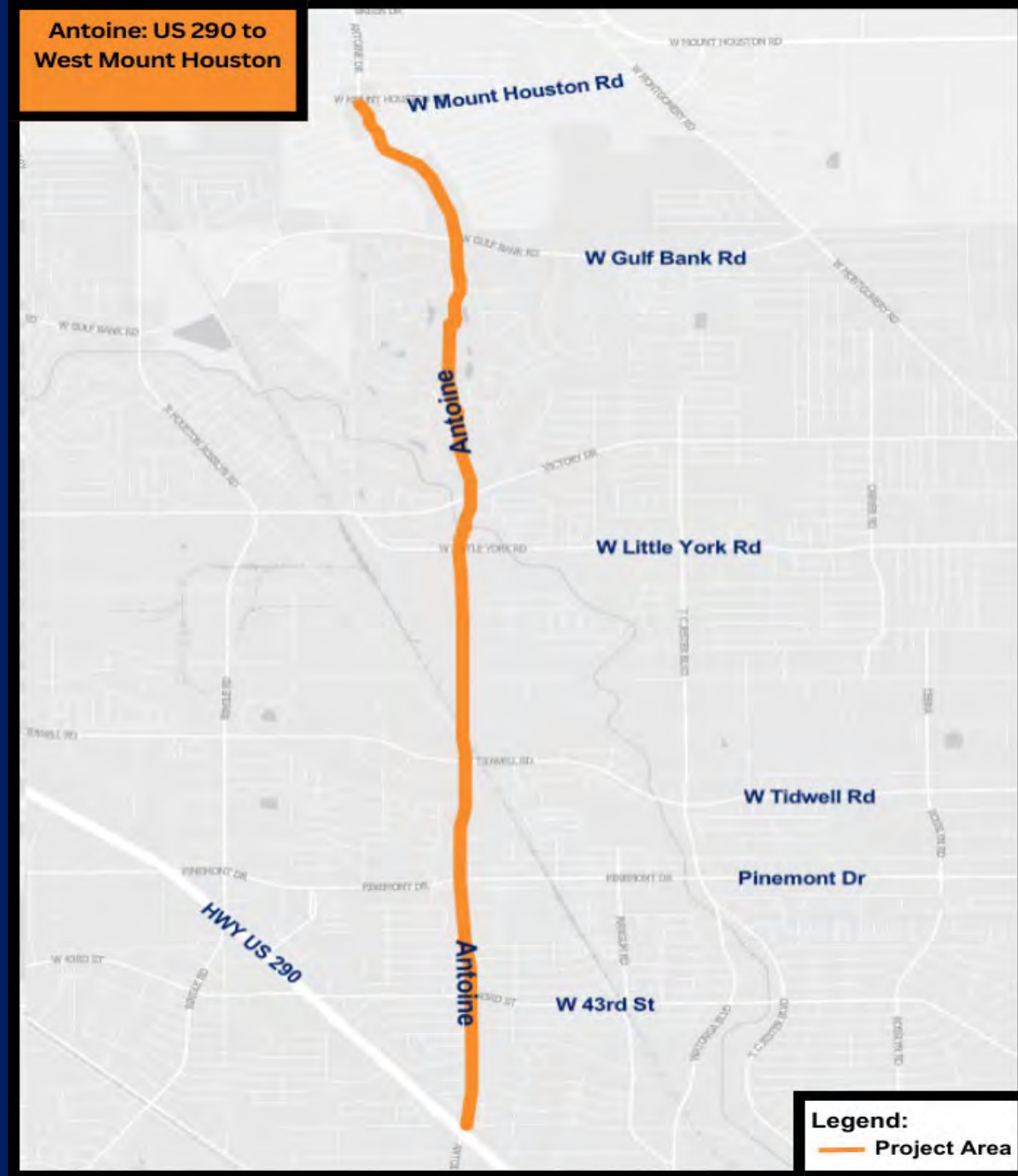



PROJECT OBJECTIVES

Proposed conditions will achieve the below



**Reconstruct
Roadway**



**Improve Mobility &
Safety for all users**

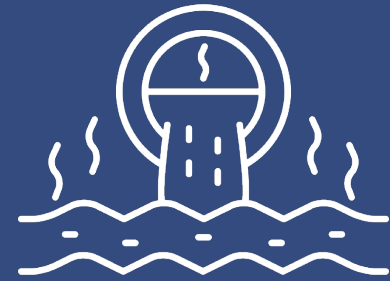

**Improve Public
Utilities**

PROJECT SCOPE



Full Roadway Reconstruction



Improve Pedestrian Facility



Upgrade Intersection Safety



Traffic Signal Replacement



Addition of Street Lighting



Four (4) proposed bridges



Improve storm sewer system



Wastewater and Water line replacement,
as required





PLANS AND ESTIMATES ARE SUBJECT TO CHANGE



ANTOINE DRIVE FROM US 290 TO W MOUNT HOUSTON

PROJECT NO: N-10030-0GEC-3

PROJECT MAP

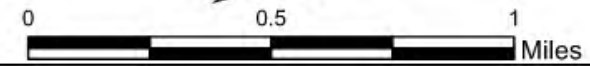

Legend

	Bridge		BNSF Railway
	Segment I		Parks
	Segment II	Council Districts	
	Streams		A
	Major Roads		C
	Local Roads		

RECOMMENDED TYPICAL SECTION

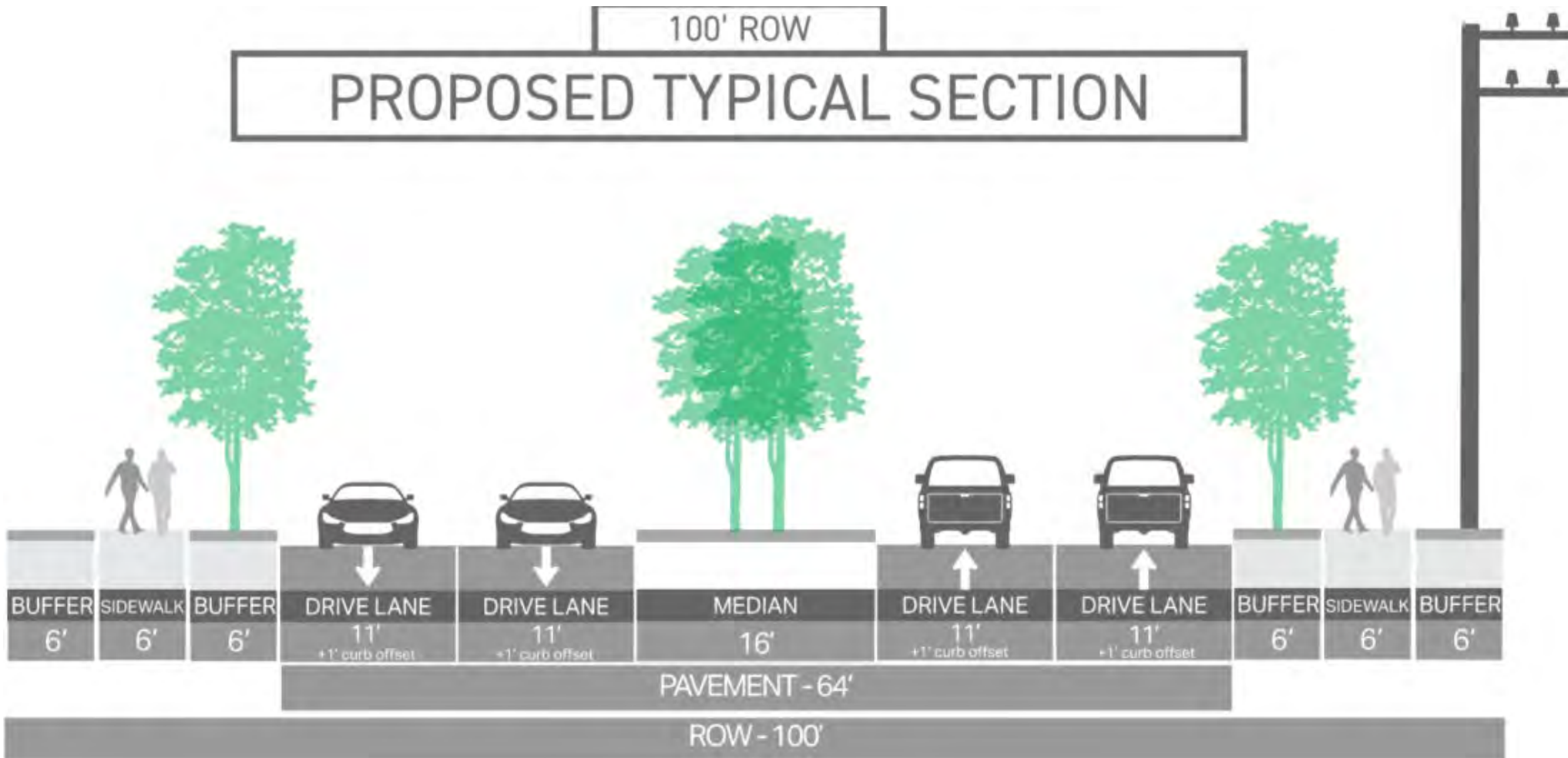

4 LANE, TYPICAL SECTION
(US 290 TO NORTH OF WEST GULF BANK)

- 3 Bridge Replacements
- Proposed BNSF Grade Separation
- Proposed Ped Bridge over BNSF Railroad



PLANS AND ESTIMATES ARE SUBJECT TO CHANGE

View the rendering at www.EngageHouston.org

NNMD INTERSECTION ENHANCEMENTS

- Near Northwest Management District
 - 8 Signalized Intersections
 - Stamped Concrete Crosswalks
 - Pavement Diamond Sawcut Patterning



Stamped Concrete Crosswalk (Example)

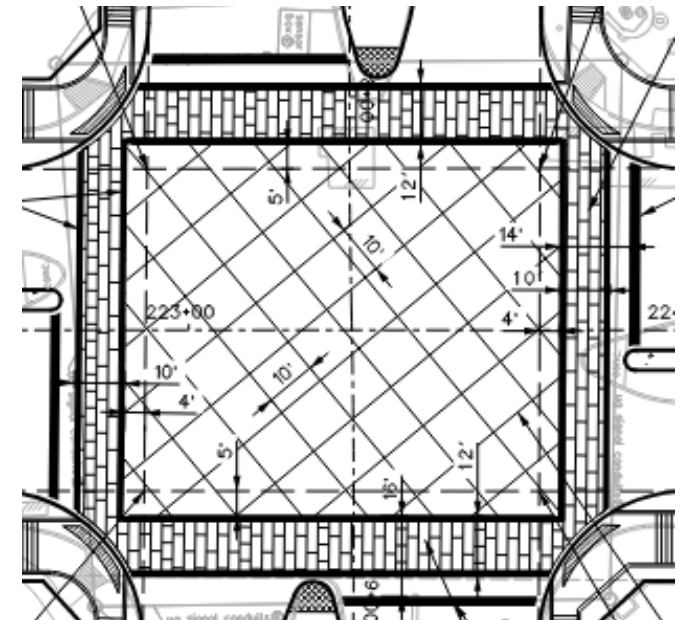

PROJECT SEASONS

WINTER

January
February
March

SPRING

April
May
June

SUMMER

July
August
September

FALL

October
November
December

ENGAGEHOUSTON.ORG



- Currently in Design Phase
- Anticipated Construction
 - Summer 2027 to Summer 2030



ENGAGEHOUSTON.ORG



- Currently in Design Phase
- Anticipated Construction
 - Spring 2029 to Spring 2034





WHO TO CONTACT



Questions? Please dial 3-1-1
visit houstontx.gov/311 (provide project name or #)



Visit engagehouston.org for
more information and ask
questions!



Send questions or comments
to engage@houstontx.gov

ENGAGEHOUSTON.ORG

SCAN
ME



Engage with us!

- Ask questions
- Post comments

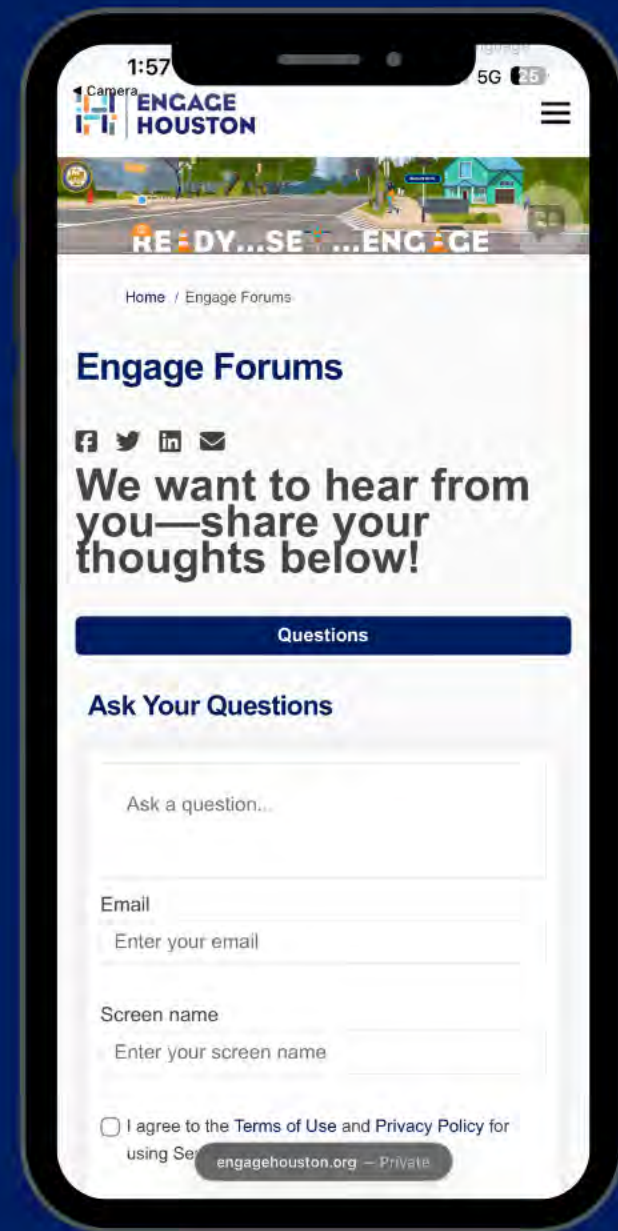

A long-exposure photograph of the Houston skyline at night. The city lights are reflected in the sky, and light trails from traffic on a multi-level highway in the foreground create a sense of motion. The text 'THANK YOU!' is overlaid in large white letters at the top.

THANK YOU!

HoustonPublicWorks.org



[@HouPublicWorks](https://twitter.com/HouPublicWorks)